



**BURIED IN FINGAL**

REGISTER OF INTERMENTS

**CHAPELMIDWAY**

1936-2010

**Comhairle Contae  
Fhine Gall**  
Fingal County  
Council



DUBLIN BOARD

OF PUBLIC HEALTH.

REGISTER OF

INTERMENTS.

..... Burial Ground.

No. of Entry	Christian Name and Surname (in full)	Religious Persuasion	Occupation or Rank in Life	Last Place of Residence	Situation of Grave Plot	Date of Death	Date of Interment	Signature of Person having Management of Interment	Signature of Registrar
1	Christopher Murray	R.C.	Blacksmith	Chapelmidway	X	20 <sup>th</sup> Jan 1936	22 <sup>nd</sup> 1. 1936	Michael Foran	Pat Mully
2	Richard Mc Nally	R.C.	Lab	Chapelmidway	X	8 <sup>th</sup> 6. 1936	9 <sup>th</sup> 6. 1936	John Markey	P. Mully
3	Catherine Murray	R.C.	X	Chapelmidway	X	7. 6. 1936	9. 11. 1936	Michael Foran	P. Mully
4	Philip McLooney	R.C.	X	Chapelmidway	X	7. 2. 1937	8. 2. 1937	John McLooney	P. Mully
5	Margaret Walsh	R.C.	X	Leinglas	F	18. 6. 1937	19. 6. 1937	Mrs Walsh	Pat Mully
6	George Dunne	R.C.	X	Chapelmidway	X	15 Dec 1937	16. 12. 1937	John Dunne	Pat Mully
7	Thomas Richard	R.C.	Lab	Shallon	X	11. Feb 1938	13. 2. 1938	Pat Richard	Pat Mully
8	Anne Dady	R.C.	X	Kilcoskan	X	19. 4. 1938	21. 4. 1938	John Dady	P. Mully
9	James Geraghty	R.C.	X	Chapelmidway	A. 1	16. 6. 1938	19. 6. 1938	John Geraghty	Pat Mully
10	Harry Dunne	R.C.	X	Harristown	A. 2	15. 10. 1938	17. 10. 1938	Thomas Dunne	Pat Mully
11	Margaret Merriman	R.C.	X	Dunsaughley	X	2. 2. 1939	4. 2. 1939	Joseph Merriman	Pat Mully
12	James Markey	R.C.	X	Kilreeck	A. 3	4. 7. 1939	6. 7. 1939	Michael Markey	Pat Mully
13	Cecilia Mc Nally	R.C.	X	Dunbray	X	27. 12. 1939	29. 12. 1939	Christopher Mc Nally	Pat Mully
14	Patrick Kelly	R.C.	X	Chapelmidway	X	25. 3. 1940	27. 3. 1940	James Kelly	P. Mully
15	James Merriman	R.C.	V	Kilreeck	X	17. 9. 1940	19. 9. 1940	John Merriman	P. Mully

DUBLIN BOARD

OF PUBLIC HEALTH.

REGISTER OF

INTERMENTS.

..... Burial Ground.

No. of Entry	Christian Name and Surname (in full)	Religious Persuasion	Occupation or Rank in Life	Last Place of Residence	Situation of Grave Plot	Date of Death	Date of Interment	Signature of Person having Management of Interment	Signature of Registrar
31	Anne Kirwan	RC	x	Corrstown	No 7 A	<sup>th</sup> 4. <sup>th</sup> 4. 1944	<sup>th</sup> 5. <sup>th</sup> 4. 1944	Michael Kirwan	Patrick Mullen
32	John Merriman	RC	x	Dubber	No 22 A	<sup>th</sup> 26. <sup>th</sup> 10. 1944	<sup>th</sup> 28. <sup>th</sup> 10. 1944	Winfred Merriman	Patrick Mullen
33	Margaret O'Brien	RC	r	Corrstown	No 8 A	<sup>th</sup> 4. <sup>th</sup> 1. 1945	<sup>th</sup> 6. <sup>th</sup> 1. 1945	John O'Brien	Patrick Mullen
34	Rose Murphy	RC	"	Boilquin <sup>th</sup> Ward		<sup>th</sup> 10. <sup>th</sup> 1. 1945	<sup>th</sup> 12. <sup>th</sup> 1. 1945	James Murphy	Patrick Mullen
35	Catherine Shils	RC	x	Mountambrose	No 23 A	<sup>th</sup> 18. <sup>th</sup> 1. 1945	<sup>th</sup> 20. <sup>th</sup> 1. 1945	Thomas Shils	Patrick Mullen
36	Michael Woods	RC	x	<sup>Smithfield</sup> 12 Arangan Terrace		<sup>th</sup> 26. <sup>th</sup> 2. 1945	<sup>th</sup> 28. <sup>th</sup> 2. 1945	J. Kelly	Patrick Mullen
37	Patricia Dempsey	RC	x	<sup>St</sup> Surlgalstown	No 24 A	<sup>th</sup> 17. <sup>th</sup> 5. 1945	<sup>th</sup> 18. <sup>th</sup> 5. 1945	Pat Dempsey	Patrick Mullen
38	James Kirwan	RC	x	Corrstown		<sup>th</sup> 25. <sup>th</sup> 7. 1945	<sup>th</sup> 26. <sup>th</sup> 7. 1945	Michael Kirwan	Patrick Mullen
39	Bernard Merriman	RC	x	Dunsaughley		<sup>th</sup> 12. <sup>th</sup> 10. 1945	<sup>th</sup> 13. <sup>th</sup> 10. 1945	James Merriman	Pat Mullen
40	Bernard McKally	RC	x	Baultry		<sup>th</sup> 3. <sup>th</sup> 3. 1946	<sup>th</sup> 4. <sup>th</sup> 4. 1946	Red McKally	Pat Mullen
41	Vera Rickard	RC	x	Shallon		<sup>th</sup> 11. <sup>th</sup> 12. 1946	<sup>th</sup> 12. <sup>th</sup> 12. 1946	Pat Rickard	Pat Mullen
42	Mary Rickard	RC	x	Shallon		<sup>th</sup> 30. <sup>th</sup> 3. 1947	<sup>th</sup> 1. <sup>th</sup> 4. 1947	Pat Rickard	Pat Mullen
43	Murael O'Brien	RC	x	Labra	No 26 A	<sup>th</sup> 8. <sup>th</sup> 4. 1947	<sup>th</sup> 9. <sup>th</sup> 4. 1947	Denis O'Brien	Pat Mullen
44	James McKally	RC	x	Dunbroe		<sup>th</sup> 8. <sup>th</sup> 4. 1947	<sup>th</sup> 10. <sup>th</sup> 4. 1947	Christ McKally	Pat Mullen
45	Margaret Hodges	RC	x	Kipshulte	No. 27. A	<sup>th</sup> 26. <sup>th</sup> 6. 1947	<sup>th</sup> 27. <sup>th</sup> 6. 1947	Ken Hodges	Pat Mullen

DUBLIN BOARD

OF PUBLIC HEALTH.

REGISTER OF

INTERMENTS.

..... Burial Ground.

No. of Entry	Christian Name and Surname (in full)	Religious Persuasion	Occupation or Rank in Life	Last Place of Residence	Situation of Grave Plot	Date of Death	Date of Interment	Signature of Person having Management of Interment	Signature of Registrar
16	John Daly	R.C.	Janitor	Kilcosham	X	5 <sup>th</sup> 11. 1940	7 <sup>th</sup> 11. 1940	Thomas Daly	Patrick Mullally
17	Mary Dowling	R.C.	-	Kilshamph	X	13 <sup>th</sup> 2. 1941	15 <sup>th</sup> 2. 1941	William Dowling	Patrick Mullally
18	Ellen Murray	R.C.	-	Chapelmidway	X	26 <sup>th</sup> 2. 1941	28 <sup>th</sup> 2. 1941	P. Ballaghan	Patrick Murray
19	Patrick M. Smith	R.C.	-	Newcastle	X	9 <sup>th</sup> 4. 1941	9 <sup>th</sup> 4. 1941	Patrick Smith	P. Mullally
20	John Kane	R.C.	-	Longwood Road Dublin M.S.R.	X	30 <sup>th</sup> 4. 1941	2 <sup>nd</sup> 4. 1941	Tom Reilly	Patrick Mullally
21	Kate Mullally	R.C.	-	Chapelmidway	X	29 <sup>th</sup> 9. 1941	1 <sup>st</sup> 10. 1941	Hugh Mullally	Patrick Mullally
22	Margaret Mullally	R.C.	-	Chapelmidway	X	12 <sup>th</sup> 12. 1941	14 <sup>th</sup> 12. 1941	Brian Mullally	Patrick Mullally
23	Francis Patchiffe	R.C.	-	New Park	X	22 <sup>nd</sup> 1. 1942	24 <sup>th</sup> 1. 1942	James Patchiffe	Patrick Mullally
24	Mary Crawford	R.C.	-	13 Moran Road Drumnaugh	X	4 <sup>th</sup> 3. 1942	6 <sup>th</sup> 3. 1942	Joseph Crawford	Patrick Mullally
25	Charles Mackin	R.C.	-	Shallon	X	27. 10. 1942	28. 10. 1942	Michael Mackin	Patrick Murray
26	Thomas Farrell	R.C.	-	Ballyteahan	X	17. 7. 1943	19. 7. 1943	Denis Farrell	Patrick Mullally
27	Margaret Merriman	R.C.	-	Kilreeck	X	24. 8. 1943	25. 8. 1943	for Merriman	Patrick Mullally
28	Denise Merriman	R.C.	-	Kilreeck	X	31. 8. 1943	1. 9. 1943	for Merriman	Patrick Mullally
29	Thomas Reilly	R.C.	-	158 <sup>th</sup> Circular R.D. Dublin	X	25. 9. 1943	28 <sup>th</sup> 9. 1943	Thos Reilly	Patrick Mullally
30	James Fennessy	R.C.	-	74 <sup>th</sup> Jarlath Road Babra	X	4 <sup>th</sup> 1. 1944	6 <sup>th</sup> 1. 1944	Thos Reilly	Patrick Mullally

DUBLIN BOARD

OF PUBLIC HEALTH.

REGISTER OF

INTERMENTS.

..... Burial Ground.

No. of Entry	Christian Name and Surname (in full)	Religious Persuasion	Occupation or Rank in Life	Last Place of Residence	Situation of Grave Plot	Date of Death	Date of Interment	Signature of Person having Management of Interment	Signature of Registrar
46	John McCabe	RC	Lab	<sup>NCR RD</sup> 17 Glangarriff	A	<sup>in</sup> 27.7.1947	<sup>in</sup> 29.7.1947	Thomas Reilly	Pattk mullally
47	Anne Ryan	RC	x	<sup>in</sup> 71 Wickford St Dublin		<sup>in</sup> 11.10.1947	<sup>in</sup> 13.10.1947	Prof. Monks	Pattk mullally
48	Patrick Dempsey	RC	x	<sup>east</sup> Longharrowtown		<sup>in</sup> 25.1.1948	<sup>in</sup> 27.1.1948	Patrick Dempsey	Pattk mullally
49	Mary Markey	RC	x	Kibresk	A-3	2.4.1948	4.4.1948	Michael Markey	Pattk mullally
50	Kate Reilly	RC	x	<sup>RD</sup> 158 N <sup>th</sup> Braculor		<sup>in</sup> 13.9.1948	<sup>in</sup> 15.9.1948	Thos Reilly	Pattk mullally
51	Margaret Markey	RC	x	Kibresk	A-3	<sup>in</sup> 17.10.1948	<sup>in</sup> 19.10.1948	Michael Markey	Pattk mullally
52	Joseph Smith	RC	x	Skipsubble	A 30	<sup>in</sup> 10.7.1949	<sup>in</sup> 11.7.1949	Peter Smith	Pattk mullally
53	Rose O'Brien	RC	x	Kelrissk	A	<sup>in</sup> 28.7.1949	<sup>in</sup> 30.7.1949	Brian O'Brien	Pattk mullally
54	Mary O'Reilly	RC	x	<sup>b. home</sup> Damastown		<sup>in</sup> 2.10.1949	<sup>in</sup> 4.10.1949	William O'Reilly	Pattk mullally
55	Patrick O'Brien	RC	x	Cabra	A 25	<sup>in</sup> 13.10.1949	<sup>in</sup> 15.10.1949	Dennis O'Brien	Pattk mullally
56	Anne Kane	RC	x	<sup>Publicist</sup> 96 Upperchurch	A 28	<sup>in</sup> 2.2.1950	<sup>in</sup> 24.1.1950	Thomas Kane	Pattk mullally
57	Christopher McNally	RC	x	Dunbro House		28-4850	30-4850	Richard McNally	Pattk mullally
58	Bernard Murphy	RC	x	Booby quay		<sup>in</sup> 27.6.1950	<sup>in</sup> 29.6.1950	Patrick Murphy	Pattk mullally
59	Annie Walsh	RC	x	Ballymun	A	19.3.1951	<sup>at</sup> 21.3.1951	John Walsh	Pattk mullally
60	Bridget Dowling	RC	x	Kilshane		<sup>in</sup> 10.4.1952	<sup>in</sup> 12.4.1952	William Dowling	Pattk mullally

DUBLIN BOARD

OF PUBLIC HEALTH.

REGISTER OF

INTERMENTS.

Chapelmidway Burial Ground.

No. of Entry	Christian Name and Surname (in full)	Religious Persuasion	Occupation or Rank in Life	Last Place of Residence	Situation of Grave Plot	Date of Death	Date of Interment	Signature of Person having Management of Interment	Signature of Registrar
61	Edward Brady	R.C.	Lab	Boobquay	A	25.9.1952	27.9.1952	Anne Brady	P. Mullenally
62	James Murphy	R.C.	Lab	Boobquay		5.6.1953	7.6.1953	Patk Murphy	P. Mullenally R 17/1/53
63	Thomas Kane	R.C.	Lab	Dubber	A	22-2-1954	24-2-1954	Thomas Kane	P. Mullenally
64	John Hanlon	R.C.	Lab	Chapelmidway	A	7.9.1954	9.9.1954	Michael Donohue	Patk Mullenally
65	Alice Donnelly	R.C.		Boonstown	A	8.10.1954	10.10.1954	John Donnelly	Patk Mullenally
66	William Doolan	R.C.	Lab	Kilshane		27.11.1954	29.12.1954	William Doolan	Patk Mullenally
67	Christina Farrell	R.C.		Ballystrahan		1.11.1955	2.11.1955	Denis Farrell	Patrick Mullenally
68	Patrick Monks	R.C.		10 B. Hill Summit Hill	A	29.2.1956	2.3.1956	P. B. Monks	Patrick Mullenally
69	Julia Daly	R.C.		Killossong		14.3.1956	15.3.1956	John Daly	Patrick Mullenally
70	Thomas Valentine	R.C.		Shallon	A	29.3.1956	31.3.1956	Ann Valentine	Patrick Mullenally (B) 15/1/56
71	Hugh Mullenally	R.C.		Shephuttle		7-12-56	9-12-56	Kathrine Mullenally	Patrick Mullenally
72	James Flanagan	R.C.		Rath Kilsallaghan	A	18-12-56	20-12-56	Patricia Flanagan	Patrick Mullenally (see P.R. 775)
73	Elizabeth Keane	R.C.		Glengriff Pde 100, B. R. Hill		14-3-57	16-3-57	Charles Keane	Patrick Mullenally
74	Ellen Scally	R.C.		Kilrush St. Margarets		2-6-57	4-6-57	Thomas Scally	Patrick Mullenally (17/4/57)
75	John Stynes	R.C.	Lab	Ballymack		23.6.1957	25.6.1957	Stephen Stynes	Patrick Mullenally (11/10/57)

DUBLIN BOARD  
REGISTER OF

OF PUBLIC HEALTH.  
INTERMENTS.

..... Burial Ground.

No. of Entry	Christian Name and Surname (in full)	Religious Persuasion	Occupation or Rank in Life	Last Place of Residence	Situation of Grave Plot	Date of Death	Date of Interment	Signature of Person having Management of Interment	Signature of Registrar
76	Mary Kane	R.C.		28 Griffith Parade		23-10-57	25-10-57	Thomas Kane	Patrick Mullally
77	Joseph Merriman	R.C.		Kilcreeck		24.4.1958	26.4.1958	Helena Merriman	Patrick Mullally
78	Thomas Shields	R.C.		Mountambrose Swords		22-7-58	24-7-58	Frank Shields	Patrick Mullally
79	Mary Farrell	R.C.		Broughan The Ward.	A	29-8-58	29-8-58	Thomas Farrell	Patrick Mullally.
80	Michael Keating	R.C.		Kilcreeck St. Margaret's	60	21-11-58	23-11-58	John Keating.	Patrick Mullally
81	Michael Donovan	R.C.		Ballystrahan St. Margaret's		20-2-59	21-2-59	Mary Donovan	Patrick Mullally.
82	Anne Stynes	R.C.		Kilcarrigan Ballyhack	A	29.5.1959	31.5.59	Stephen Stynes	Patrick Mullally
83	Alicea Brien	R.C.		Dunbroe	A 32	2.7.1959	5.7.1959	Joe Brien	Patk Mullally
84	Patrick Mullally	R.C.		Shibbuble		30-8-1959	2-8-1959	Brian Mullally	Brian Mullally
85	John Walsh	R.C.		Ballymun		20-11-60	23-11-60	Thomas Kelly.	Brian Mullally
86	John O'Brien	R.C.		Corrstown town	43 A	29-3-61	29-3-61		Patrick G. empsey
87	John Stynes	R.C.	Labourer	Ballyhack Kilsalliar		19-7-61	21-7-61	Stephen Stynes	Patrick G. empsey
88	Tomas Ryan	R.C.	Labourer	Kilsoy	A17	8-9-61	7-9-61	M <sup>r</sup> Proctor Swords	Patrick G. empsey
89	Tomas Murtha	R.C.	Labourer	Liffale	B A	11-3-11-61	5-11-61	M <sup>rs</sup> Murtha	Patrick G. empsey
90	Kate Macken Infont	R.C.	-	Donoughage St. Margaret's	A	1-12-62	1-13-62	Michael Macken	Patrick G. empsey

16/1/6  
3/1/1

DUBLIN BOARD

OF PUBLIC HEALTH.

REGISTER OF

INTERMENTS.

CHAPEL MIDWAY

Burial Ground.

No. of Entry	Christian Name and Surname (in full)	Religious Persuasion	Occupation or Rank in Life	Last Place of Residence	Situation of Grave Plot	Date of Death	Date of Interment	Signature of Person having Management of Interment	Signature of Registrar
91	Luke Rickard	R.C.	Labr.	Kilsallaghan	old ground	22.1.62	24.1.62	Jane Rickard	Patrick Dempsey.
92	Elizabeth Murray	R.C.	-	320 Colley Rd Drimmagh	old ground	23.1.62	24.1.62	Anne Clarke Bables Road	Patrick Dempsey
93	Patrick Murray	R.C.	Labr	St Margarets	37 A	13-2-62	15-2-62	Thomas Farrell The Ward	Patrick Dempsey
94	Mrs Kate Byrne	R.C.	-	Newpark The Ward	A	3-3-62	5-3-62	Jane Wade The Ward	Patrick Dempsey
95	Mr William Hallighan	Kilsallaghan R.C.	-	Kilsallaghan	A	24-3-62	25-3-62	Mr Keiver Hallighan	Patrick Dempsey
96	Mrs Anne McCabe	R.C.	-	Glengarriff Parade	A	8-6-62	9-6-62	Mr Bourke Undertaker	Patrick Dempsey
97	Mrs Margaret Byrne	R.C.	-	The Ward	A	13-4-62	15-4-62	Mr Anne Kitching Ward	Patrick Dempsey
98	James Bradys	R.C.	Labr	Finglas	A	19-8-62	22-8-62	Mrs Bradys	Patrick Dempsey 20/8/62
99	Mrs Femesey	R.C.	-	Jarbother Cabna (R.D)	0-1	17-11-62	19-11-62	James Reddy	Patrick Dempsey 19/11/62
100	Laurence Rice	R.C.	-	Caltra West	48 SEC. A	20-8-63	22-8-63	Joseph Harmon Undertaker	Patrick Dempsey
101	Margaret Dunne	R.C.	-	Dubber Finglas	37 Set A	9-3-64	11-3-64	Joseph Harmon	Patrick Dempsey
102	Thomas Dunne Harristown 2nd Margarets	R.C.	-	Harristown St Margarets	Set 1-2 = A	15-3-64	17-3-64	Patrick Dunne	Patrick Dempsey
103	John Hallighan	R.C.	-	Ballyhack Kilsallaghan	Set 6 A	19-4-64	21-4-64	Mr Keiver Hallighan Kilsallaghan	Patrick Dempsey
104	John McDermid	R.C.	-	St Margarets	7 A	12-5-64	14-5-64	Braydon McDermid	Patrick Dempsey 19/5/64
105	Bernard Mullaly	R.C.	-	St Margarets	old ground	6-9-64	8-9-64	Mrs Anne Mullaly	Patrick Dempsey

DUBLIN BOARD

OF PUBLIC HEALTH.

REGISTER OF

INTERMENTS.

CHAPEL MIDWAY

Burial Ground.

No. of Entry	Christian Name and Surname (in full)	Religious Persuasion	Occupation or Rank in Life	Last Place of Residence	Situation of Grave Plot	Date of Death	Date of Interment	Signature of Person having Management of Interment	Signature of Registrar
106	Patrick Murphy	RC	Labourer	Kilsonken St Margarets	40 Old Ground	19-10-64	21-10-64	Mr Rock Swords	Patrick Gempsey
107	Michael O'Kally	RC	Labourer	Bumbrow St Margarets	41 Old Ground	3-11-64	5-11-64	Mr Rock Swords	Patrick Gempsey 11/1/65
108	Margaret Keddy	RC	-	Dubber Finglas	A Plot	15-8-65	17-8-65	Messrs Undertaker	Patrick Gempsey 19/10/65
109	Mrs Josephine O'aly	RC	-	Robertson	50	19-3-66	26-3-66	Mr Rock Swords	Patrick Gempsey
100	Mrs Margaret E. Gempsey	RC	-	Shippwobbe St Margarets	20	14-5-66	16-5-66	Mr Rock Swords	Patrick Gempsey 4/4/66
101	Mrs Margaret Reilly	RC	-	Phiphobora Cottages	30	21-5-66	23-5-66	Mr Bourke R cone St	Patrick Gempsey
102	Patrick Murphy	RC	-	Sunglostown Kilsallaghan	15	15-10-66	17-10-66	Dennis Farrell	Patrick Gempsey
103	Denis O'Brien	RC	-	499 Cooghough RD Calve West Dublin	22 Plot	20-10-66	22-10-66	Mr Rock Swords	Patrick Gempsey
104	Peter Smith	RC	Labourer	Denetery Road Calve West	16 A	23-5-67	26-5-67	Burkes & Co St	Patrick Gempsey 7/2/67 31/12/66 4/8/67
105	Kateite Pogue	RC	-	St Kevens Jones Street	17 A	20-8-67	22-8-67	Mr Rock Swords	Patrick Gempsey
106	Noel William Sognat	RC	Labourer	Maker Hospital	A 18	9-11-67	11-11-67	Fanaghan Jennings St	Patrick Gempsey 1/1/68
107	Mrs Anne Keating Kilgusht St Margarets	RC	-	Kilmeash	A 60	22-2-68	25-2-68	Mr Gilmer Paul	Patrick Gempsey
108	Mrs S. D. O'Sullivan Esplanade St Margarets	RC	-	13 Albert Street St Margarets	-	13-3-68	15-3-68	Mr John Rock	Patrick Gempsey
109	Matthew Sognat Newtown Cottages St Margarets	RC	Labourer	7 Newtown Cottages St Margarets	A 19	29-3-68	1-4-68	Mr John Rock Swords	Patrick Gempsey
110	Eugene Sheils	RC	Labourer	St Marys Houplake	A 20	2-6-68	4-6-68	Mr John Rock Swords	Patrick Gempsey

DUBLIN BOARD

OF PUBLIC HEALTH.

REGISTER OF

INTERMENTS.

CHAPEL MIDWAY

Burial Ground.

No. of Entry	Christian Name and Surname (in full)	Religious Persuasion	Occupation or Rank in Life	Last Place of Residence	Situation of Grave Plot	Date of Death	Date of Interment	Signature of Person having Management of Interment	Signature of Registrar
201	Patrick McCormack	R.C.	Fab	Dover 14 Rathfriland	1	22-6-68	25-6-68	Mr Rock Swords	Patrick Sheehan
212	Mrs Anne Brady	R.C.	—	Kilcoshmen The Ward	60	20-7-68	22-7-68	Messers Bros	Patrick Sheehan
213	PATRICK DEMPSEY	R.C.	—	SURGALSTOWN KILSHALLAGHAN CO DUBLIN	24 <sup>A</sup>	6-10-68	8-10-68	MR ROCK SWORDS	Patrick Sheehan
214	Miss Jane Kelly	R.C.	—	Surgalstown Swords, Co. Dub.	—	17-7-69	19-7-69	Mr Rock Swords	Peter Sheehan 8-7-69
215	Mr Michael Byrne	R.C.	—	—	416 A	—	—	Fenigans	Peter Sheehan
216	<del>James Bennett</del>	<del>R.C.</del>	—	<del>The Lane</del>	—	<del>18-11-70</del>	<del>20-11-70</del>	<del>Messers Fenigans</del>	<del>Peter Sheehan</del>
217	Mr Christy Reilly	R.C.	—	Barr Lodge, Ballynash	—	29-5-71	31-5-71	P.M. - Baul	Peter Sheehan 31-5-71
218	Paddy Daly	R.C.	—	The Rath Swords	—	26-10-71	28-10-71	John Daly	Peter Sheehan 28-10-71
219	Mrs Ann Mullaly	R.C.	—	Chapelmidway	A	3-4-72	5-4-72	Peter Mullaly	Peter Sheehan 5-4-72
220	Mr Frank Farrell	R.C.	—	Kilbuck, St Margarets	A	8-4-72	10-4-72	Dermot Farrell	Peter Sheehan 10-4-72
221	Mr Matthew Lynch	R.C.	—	Detown, St. Margarets	A	21-3-72	23-3-72	Paddy Lynch	Peter Sheehan
222	Mr THOMAS Mullaly	R.C.	—	Boquer's Hill and Slonarf	A 52	22-3-72	26-3-72	Thomas J. Mullaly	Peter Sheehan 11/3/72 14/4/72
223	Mr James Merriman	R.C.	—	Dunsonghy S.K. Margarets	A	9-4-73	11-4-73	Mr Rock Swords	Peter Sheehan 11-4-73
224	FLORENCE RATHLIFFE	R.C.	—	NEW PARK THE WARD	—	30-4-75	2-5-75	B. Ratcliffe	Christy Sheehan CH 14/5/75
225	MARY DONAGHUE	R.C.	—	CHAPLE MIDWAY ST MARGARETS	—	16-1-76	19-1-76	Bill Donoghue	Christy Sheehan

DUBLIN BOARD

OF PUBLIC HEALTH.

REGISTER OF

INTERMENTS.

*Chapelmidway*.....Burial Ground.

No. of Entry	Christian Name and Surname (in full)	Religious Persuasion	Occupation or Rank in Life	Last Place of Residence	Situation of Grave Plot	Date of Death	Date of Interment	Signature of Person having Management of Interment UNDERTAKER.	Signature of Registrar
226	Patrick Bligh.	R. C.	Mechanic	167 Dorset	A 55	3. 3. 76	6. 3. 76	Mrs O Toole	<i>John Cottell</i>
227	Miss Julia Dolan	R. C.	Old age Pension	KILSHANE Finglas		11. 8. 76	13. 8. 76	William Dolan	<i>John Cottell</i>
228	Michelle Morrison		Baby	Harristown	Old Sec	16-12-76	17-12-76	Sean Rock	<i>J Morley</i> <sup>29/12/76</sup> <sup>29/1/77</sup>
229	Charles Flood			St Margarets 37 Mc Kelvey Ave Finglas	No 2 - A	16-12-77	19-12-77	S Rock	<i>J Morley</i>
230	Desmond Brennan	R. C.		New Park. the Ward	No 49 A	31-1-78	2-2-78	Mc Entaggart Burke	<i>J Morley</i>
231	James Radcliffe.	R. C.		Kilrossery Rawlston	5 A	14-2-78	16-2-78	Queen St	<i>J Morley</i>
232	Katherine Dady	R. C.	age 64	Coolat Rath Newpark the Ward	old Section 37 A.	7-4-78	9-4-78	Sean Rock Cunningham (undertakers)	<i>Niall Fargan</i>
233	Patrick Synnott	R. C.	AGE 57	Kilreask st. Margarets	old Section	11-9-78	13-9-78	Gilsenan undertakers.	<i>Niall Fargan</i>
234	Dennis Farrell	R. C.	AGE 96	33 Drumcliffe Rd Dublin	35B. A.	29-12-78	1-1-79	Burke's (undertakers)	<i>Niall Fargan</i> <sup>7/5/79</sup>
235	Anne Rice	R. C.	AGE 65	Kannistown St. Margarets	54 SEC. A.	17-7-79	19-7-79	Sean Rock	<i>Niall Fargan</i>
236	Laurence O Toole	R. C.	81	KILREASK ST. MARGARETS.		30-12-79	1-1-80	SEAN ROCK	<i>Niall Fargan</i>
237	BERNARD O'BRIEN	R. C.	80	KILREASK ST. MARGARETS.	OLD SECTION.	13-4-80	15-4-80	CHRISTY GILSENAN.	<i>Niall Fargan</i>
238	DENNIS FARRELL		80	KILREASK ST. MARGARETS.	OLD SECTION.	29-1-81	1-1-81	CHRISTY GILSENAN.	<i>Niall Fargan</i> <sup>July 2-81</sup>
239	MARTHA DAVY		Baby	DUNSOUGHLY ST. MARGARETS 131 Nicholas Rd.	71 A.	20-3-81	24-3-81	SEAN ROCK	<i>Niall Fargan</i> <sup>2ND INTERMENT.</sup>
240.	THOMAS MULLALLY		54	CHARLTON CUM HARDY MANCHESTER.	old Section	25.8.81.	29.8.81	FANAGAN'S.	<i>Niall Fargan</i> <sup>1st INTERMENT.</sup>

DUBLIN BOARD

OF PUBLIC HEALTH.

REGISTER OF

INTERMENTS.

*Chapel midway*

..... Burial Ground.

No. of Entry	Christian Name and Surname (in full)	Religious Persuasion	Occupation or Rank in Life	Last Place of Residence	Situation of Grave Plot	Date of Death	Date of Interment	Signature of Person having Management of Interment	Signature of Registrar
241	Peter Smith	RC	Pouchman.	Edalton The Ward	27 A	26/3/1982	28/3/1982	Mr. Cunningham. Clousila	Richard Kennedy 2 <sup>nd</sup> Interment
242	Thomas Lynch	RC	Shunter.	Melbourne KINCOSMAN	A 36	23/3/1982	27/3/1982	Sean Rock.	Richard Kennedy 2 <sup>nd</sup> Interment
243	JOHN DALY	RC	LABOURER.	THE WARD Co. DUBLIN	Old SECTION	10-9-82	12-9-82	SEAN ROCK	Desmond Kelly 1 <sup>st</sup> Interment
244	BRIGID DEMPSEY	RC	HOUSEWIFE.	SURGAISTOWN KILLSALLAGHAN Co. DUBLIN	A-24	19-9-82	21-9-82	SEAN ROCK	Desmond Kelly 2 <sup>nd</sup> Interment
245	Mary Geraghty	RC	HOUSEWIFE.	Dunsoughly St Margarets	A-66	29-10-82	31-10-82	SEAN ROCK	Desmond Kelly 1 <sup>st</sup> Interment
246	Charles Brennan	RC		37 M'Kelvey Ave Finglas Kilcosman	A 49.	16-11-82	18-11-82	M'Entaggart	Desmond Kelly 2 <sup>nd</sup> Interment
247	Mary Daly	RC	Housewife.	The Ward Co. Dublin Commons East The Gran Swords	Old Section	5-1-84	7-10-84	Sean Rock	Desmond Kelly 2 <sup>nd</sup> Interment
248	John Markey	RC	Labourer.	Maunten The Ward	A-50	13-8-83	15-8-83	Sean Rock 14 8 83	Desmond Kelly 1 <sup>st</sup> Interment
249	Patricia Mulhally	RC	Housewife.	Conquest Hill, Clontarf	A 52	8-11-84	9-10-84	Jennings.	John Gowan 2 <sup>nd</sup> Interment
250	Teresa Geraghty	RC	Housekeeper.	Dunsoughly St Margarets	A-66	10-12-85	12-12-85	S. Rock	P. Kelly 2 <sup>nd</sup> Interment
251	Michael Donoghue	RC	Retired.	Chapel midway St Margarets		20-12-85	22-12-85	S. Rock	PD Kelly 2 <sup>nd</sup> Interment
252	Mary Stynes	RC	Housewife.	9 Rivermeade Drive Sword	Old Section	19-5-86	20-5-86	S. Rock	PD Kelly 1 <sup>st</sup> Interment
253	Patrick Markey	RC	Labourer.	Wellbush Lane St Margarets	A-3	13-8-86	15-8-86	Stafford	PD Kelly 4 <sup>th</sup> Interment
254	Kathleen O'Brien	RC	Housewife.	10 Cannon Burye Flats Cabra West	A	23-2-87	25-2-87	S. Rock	PD Kelly 3 <sup>rd</sup> Interment
255	Ann (Nancy) Power	RC	Housewife.	Shepable St Margarets Co Dublin	Old Section	3-8-87	5-8-87	C Gibson	PD Kelly 2 <sup>nd</sup> Interment

DUBLIN BOARD

OF PUBLIC HEALTH.

REGISTER OF

INTERMENTS.

CHAPEL H. D. N. A. /

Burial Ground.

No. of Entry	Christian Name and Surname (in full)	Religious Persuasion	Occupation or Rank in Life	Last Place of Residence	Situation of Grave Plot	Date of Death	Date of Interment	Signature of Person having Management of Interment	Signature of Registrar
256	Richard M. Nally	RC	Retiree I.S.B.	12 Newtown Cottages St Margarets Co. Dublin Drumtrae	A-64	14.11.87	17.11.87	Sean Rock	P. Kelly.
257	Stephen Brien	R/C	-	St. Margarets 13 Newtown Cottages	A-32	15.3.88	17.3.88	S. Rock	Albert Austin
258	Michael Macken	RC	-	St. Margarets Dubber Cross.	Old Section	5.6.88	7.6.88	Fanagano	J. Lacey.
259	Margaret Fanning	R/C	Housewife.	Finglas. 39 Rwermeade Park	A 63	19.12.88	21.12.88	Fanning.	Albert Austin
260	Patrick O'Brien	RC	-	St. MARGARETS	A 67	31.1.89	2.2.89	M. Rock.	Albert Austin.
261	Margaret McDonnell	R/C	Housewife.	St. Margarets Cormstown	L1-A	26.2.89	28.2.89	Fanning.	Albert Austin.
262	Mae O'Brien	R/C	Housewife	Kilsallahan	A 67 Old Section	8.8.89	10.8.89	M. Rock	Albert Austin. F.Y. 5.2.90
263	MARY HANNIGAN KAVIN HANNIGAN	R/C R/C	- -	KILSALLACHAN KILSALLACHAN	A 42	27-2-90 23-1-90	3-3-90 26-1-90	SEAN ROCK	John Potters
264	JAMES MARKEY	R.C	-	KILREASK ST MARGARETS	A.3 OLD SECTION	4.7.90	6.7.90	SEAN ROCK	John Potters FULL
265	HANORA HOSEY	R.C	-	104 CAPPAGH RD	A-66	20.9.90	22.9.90	SEAN ROCK	John Potters
266	JENNY THOMAS RICHARD	R.C	-	SURGALSTOWN	OLD SECTION	22-10-91	25-10-91	GILSENAN	John Potters
267	PETER MAHON	R.C	-	112 TOLKA ESTATE GLASNEVIN	65 SEC-A	16-7-92	18-7-92	FANAGAN	John Potters PAGE 12 PURCHASER BH
268	PATRICK SMYTH	RC	-	1 NEW TOWN COTTAGES ST MARGARETS	4 SEC-A	20-9-92	23-9-92	PADDY MASSEY	John Potters PAGE I PURCHASER BH
269	BRIDGET SKALLY	R.C	-	KILREASK ST MARGARETS	OLD SECTION	19-10-92	21-10-92	MASSEY	John Potters
270	JOSEPH BRIEN	R.C	-	DUNBRO ST MARGARETS	62 SEC-A	5-1-93	7-1-93	SEAN ROCK	John Potters PAGE 12 PURCHASER BH

DUBLIN BOARD  
REGISTER OF

OF PUBLIC HEALTH.  
INTERMENTS.

CHAPLE MIDWAY.....Burial Ground.

No. of Entry	Christian Name and Surname (in full)	Religious Persuasion	Occupation or Rank in Life	Last Place of Residence	Situation of Grave Plot	Date of Death	Date of Interment	Signature of Person having Management of Interment	Signature of Registrar
271	JANE MERRIMAN	R.C		DUNSOGHLY ST MARGARETS	OLD SECTION	26.5.93	28.5.93	SEAN ROCK	John Pothers
272	DENIS FARRELL	R.C	AGE 71	16 JOHNSTOWN PA GLASNAVIN	OLD SECTION	3-8-93	5-8-93	SEAN ROCK	John Pothers
273	ELIZABETH FLOOD	R.C	AGE 85	HARRISTOWN ST MARGARETS		21-9-93	23-9-93	SEAN ROCK	John Pothers
274	ELIZABETH FARRELL	R.C	AGE 74	THE BROCK INN WARD CO DUBLIN	29 SEC-A	8-1-94	11-1-94	FANAGANS	John Pothers PAGE 5 PURCHASER Bk
275	GENEVIEVE SMYTH	R.C	AGE 73	1 NEWTOWN COTTAGES ST MARGARETS	4 SEC-A	21-4-94	24-1-94	SEAN ROCK	John Pothers PAGE 1 PURCHASER Bk
276	JANE DAVY	R.C	AGE 85	15 NEWTOWN COTTAGES 50 STRAND MILLS RD	71- SEC-A	9-7-95	12-7-95	MICHAEL ROCK	John Pothers PAGE 11 PURCHASER Bk
277	CHRISTINA VALENTINE	R.C	AGE 76	PORTHARNOCK 16 JOHNSTOWN PA	31- SEC-A	21-8-95	23-8-95	CUNNINGHAM'S	John Pothers PAGE 6 PURCHASER Bk
278	SHEILA FARRELL	R.C	AGE 73	CABRA	OLD SECTION	31-8-95	2-9-95	SEAN ROCK	John Pothers
279	ELLEN DALY		AGE 83	BALLYHACK MILLSBALLAGHAN	OLD SECTION	20.1.96.	22.1.96.	SEAN ROCK.	Niall Gargan.
280	ROSELEEN MURPHY	R.C	OLD SECTION	COOLQUAY THE WARD	OLD SECTION	21-11-96	23-11-96	H. ROCK	John Pothers
281	JAMES BYRNE		55	CHAPLE MIDWAY	59 A.	19.12.96.	21.12.96.	M. ROCK.	Niall Gargan. PAGE 11 PURCHASE BOOK.
282	JOHN KANE	R.C	AGE 91	38 SPERRIN RD DRIMNAGH		25-12-96	28-12-96	ROM MASSEY	John Pothers
283	THOMAS SCALLY	R.C	AGE 79	KILREASH ST MARGARETS	OLD SECTION	5.2.97	7.2.97	MASSEY	John Pothers
284	JAMES SCALLY	R.C	AGE 83	35 JAYESTOWN RD FINGLAS	OLD SECTION	30.8.97	2-9-97	MASSEY BROS	John Pothers
285	ALOYSIUS M'NALLY	R.C	AGE 64	73 EDGEWOOD LANE BLANCHARDSTOWN	OLD SECTION	15-1-98	17-1-98	M. ROCK	John Pothers

# KILLOSSERY

DUBLIN BOARD

OF PUBLIC HEALTH.

## REGISTER OF

## INTERMENTS. Robestown

Burial Ground.

No. of Entry	Christian Name and Surname (in full)	Religious Persuasion	Occupation or Rank in Life	Last Place of Residence	Situation of Grave Plot	Date of Death	Date of Interment	Signature of Person having Management of Interment	Signature of Registrar
108	Patrick Murtha	C	Labourer	Robestown	40	5-3-65	6-3-65	Mr Rock Swords	Patrick Gempsey
109	John Evans	C	Labourer	Robestown	28	2-2-65	3-2-65	Mr Rock Swords	Patrick Gempsey
200	Patrick Brien	R.C.	Labourer	Shornontown Kilsallaghan	48	26-4-66	4-28-66	Mr Gilegan 5 Maul	Patrick Gempsey J. G. Hone 4/11/67 31/12/66
201	Mrs Catherine L. O'Riordan	R.C.	—	R. W. O'Riordan Swords	49	<del>10-9-67</del> 9-19-67	10-9-67	Mr Rock Swords	Patrick Gempsey 16/1/68 3/11/67
202	Mc Anne Mc Kenna	R.C.	—	Mc Kenna	60	2-2-68	29-2-68	Mr Rock Swords	Patrick Gempsey 27/4/68 11/7/69
203	Terese Barrwell	R.C.	—	The Leas		18-11-70	20-11-70	Maryann Lawless	Peter Sheehan 7-2-71
204	Mrs Barrydys	R.C.	—	Lisheffles		12-6-74	14-6-74	T. Cassidy	Peter Sheehan 16-6-74 12/12/77 14/1/75 29/11/76 Cassidy
205	JOSEPH KELLY	AGE 85	FARMER.	Whitestown Oldtown.	See Burial in Killossery.	23-3-81	25-3-81	CHAISTY GILSENAN July 7-11-83	Niall Gargan Permission granted from the Minister of the Environment
206	Catherine Manning	AGE 83	Housewife	No 7 Dubber Cross Linglas	54-A	18-7-84	21-7-84	Sean Rock July 5-12-83 July 3-4-84	Desmond Kelly 2nd interment
207	JOHN MERRIMAN	48 YRS.	Married	25 Newtown St. Tonbeg Rd.	22-a	23-11-84	27-11-84	W. F. O'Connell	John Gowan
208	John Walsh	92 yrs	Married	L. Commons West Swords	Old Section	14-7-86	16-7-86	S. Rock	Patrick Kelly
209	Gretta Manning	62 years	—	57 Casement Drive Linglas West	22 A	5-11-86	7-11-86	W. O'Connell	Sam Ryan 3rd interment
210	Margaret Murtagh	89	Married	Balafra Swords	LYA	28-2-88	1-3-88	S. Rock	Albert Austin 2nd interment
211	Terence Mc Kenna	72	Married	Coolduff The Sand.	Old Sec.	30-4-88	3-8-88	S. Rock	Albert Austin

DUBLIN BOARD

KILLOSSERY

OF PUBLIC HEALTH.

REGISTER OF

INTERMENTS.

..... Burial Ground.

No. of Entry	Christian Name and Surname (in full)	Religious Persuasion	Occupation or Rank in Life	Last Place of Residence	Situation of Grave Plot	Date of Death	Date of Interment	Signature of Person having Management of Interment	Signature of Registrar
212	Annie Walker	R/C	HOUSEWIFE	KILSALAHAN	KILLOSSARY. NORTHSIDE OF RUISE	21. 3. 79	23. 3. 89	H. ROCK.	Albert Austin
213	[REDACTED]	[REDACTED]	[REDACTED]	[REDACTED]	[REDACTED]				
214									

Comhairle Contae Fhine Gall

Fingal County Council

DUBLIN BOARD

OF PUBLIC HEALTH.

REGISTER OF

INTERMENTS.

CHAPELMIDWAY

Burial Ground.

No. of Entry	Christian Name and Surname (in full)	Religious Persuasion	Occupation or Rank in Life	Last Place of Residence	Situation of Grave Plot	Date of Death	Date of Interment	Signature of Person having Management of Interment	Signature of Registrar
286	MARIE KEATING	R.C	AGE 72	760 COLLINS AV DUBLIN 11	56-SEC-A	1-2-98	4-2-98	MICHAEL ROCK	John Pothus PAGE 10 PURCHASE BOOK
287	MARGARET SYNNOTT	R.C	AGE 81	101 SEAVIEW PK PORTRANE SHALLON	37-SEC-A	29-7-98	1-8-98	M. ROCK	John Pothus
288	ANNIE VALENTINE	R.C	AGE 84	THE WARD 57 CASTLENT DRIVE	34-SEC-A	22-9-98	25-9-98	M. ROCK	John Pothus PAGE 4 PURCHASE BOOK
289	ANN DUNNE	R.C	AGE 48	FINGLAS WEST NEWTOWN COTTAGES	22-SEC-A	16-1-99	22-1-99	ASHES	John Pothus PAGE 2 PURCHASE BOOK
290	KATHLEEN LYNCH	R.C	AGE 92	ST MARGARETS	36-SEC-A	24-1-99	26-1-99	M. ROCK	John Pothus PAGE 8 PURCHASE BOOK
291	MAUREEN BRADY	R.C	AGE 86	89 JAMESTOWN RD FINGLAS	25-SEC-A	29-10-99	1-11-99	MASSEY	John Pothus PAGE 4 PURCHASE BOOK
292	MARY RICHARD	R.C	AGE 88	SHALLON THE WARD CO DUBLIN	OLD SECTION	2-11-99	4-11-99	C. GILSENAN	John Pothus
293	ROBERT Mc NALLY	RC	74	20 ROSEGLEEN AVE KILBARRICK D.S.	OLD SECTION	1-8-00	4-8-00	M. ROCK.	Alan Devine
294	ANNIE MAHON	RC	76	112 TOLKA ESTATE GLASNEVIN	65 A.	4-4-01	7-4-01	FANAGAN.	Alan Devine PAGE 12 PURCHASE BK
295	ANNIE 'NAN' MAUCKEN	RC	94	13 NEWTOWN COTTAGES ST. MARGARETS	OLD SECTION	15-4-01	17-4-01	FANAGAN	Alan Devine
296	SEAN SCALLY	RC	74	KILREASK ST. MARGARETS	OLD SECTION	17-5-01	21-5-01	MASSEY BROS	Alan Devine
297	PATRICIA SKELLY	RC	75	35 JAMESTOWN RD	OLD SECTION	11-2-02	15-2-02	MASSEY BROS.	Alan Devine
298	MICHAEL KIRWAN	RC	90	KILSALAGHAN	7 A.	13-4-02	16-4-02	M. ROCK.	Alan Devine PAGE 2 PURCHASE BK
299	SEAN KEATING	RC	85	COLLINS AVE EXT.	56 A.	15-2-03	18-2-03	M. ROCK.	Alan Devine PAGE 10 PURCHASE BK
300	STEPHEN STYNES	RC	84	KILSALAGHAN	OLD SECTION	20-2-03	22-2-03	M. ROCK.	Alan Devine PAGE 5 PURCHASE BK

DUBLIN BOARD

OF PUBLIC HEALTH.

REGISTER OF

INTERMENTS.

CHAPLENDWAY, Burial Ground.

No. of Entry	Christian Name and Surname (in full)	Religious Persuasion	Occupation or Rank in Life	Last Place of Residence	Situation of Grave Plot	Date of Death	Date of Interment	Signature of Person having Management of Interment	Signature of Registrar
301	WILLIAM DOOLIN	RC.	RETD.	KILLSHANE NORTH RD	OLD SECTION	4. 11. 03	6. 11. 03.	FANAGANS	Alan Devine (Room for one more.)
302.	DANIEL DAUM	RC	STUDENT.	15 NEWTOWN COMAGIES	71 A.	16. 12. 03	9. 1. 04	M. ROCK.	Alan Devine (PAGE 4 PURCHASE BK)
303	ELIZABETH McNALLY	RC.	RETD	12 NEWTOWN COMAGIES	64 A	24-1-04	29-1-04	M. ROCK.	Alan Devine (PAGE 11 PURCHASE BK)
304	ELIZABETH KIRWAN	RC	H/WIFE.	KILLSALLAGHAN	7 A.	27-7-04	31-7-04	M. ROCK.	Alan Devine (PAGE 2 PURCHASE BK)
305	AGNES SMITH.	RC	H/WIFE	33 VENTRY RD.	38 A.	25. 12. 04	29. 12. 04	MASSEY BROS	Alan Devine (PAGE 7 PURCHASE BK)
306	SEAN GERAGHTY.	RC	RETD	BALLYSTRAHAN. SHALLON	OLD SECTION	27-4-05	30-4-05	M. ROCK.	Alan Devine
307	PATRICK SMITH.	RC	RETD	THE WARD	27 A	23-7-05	27-7-05	M. ROCK.	Alan Devine
308.	BRIDGET RUSSELL	RC.	H/WIFE.	62 MEATH SQ. NORTH RD FINGLAS	OLD SECTION	6-3-06	10-3-06.	PAUL O HARE.	Alan Devine
309	JOSEPH BROWN	RC.	RETD.	DUNBRO ST. MARGARETS. 64 DUNARD COURT	62 A.	18-10-06	23-10-06	M. ROCK.	Alan Devine (PAGE 12. BOOK. 1)
310	PETER O BRIEN	RC	RETD	CABRA WEST, BRENDAN BEHAN	19 A.	9. 12. 06	12. 12. 06	M. ROCK.	Alan Devine (PAGE 2. BOOK. 1)
311	FRANCIS FARRELLY	RC	RETD.	COURT D. 1 MADONNA LODGE.	OLD SECTION	30-10-07	2-11-07.	M. ROCK.	Alan Devine
312.	CHRISTOPHER DAUM	RC.	RETD.	ROBSTOWN SANDY HILLS	OLD SECTION	5-12-08.	8-12-08	M. ROCK.	Alan Devine
313	CON McDONNELL	R.C		ST. MARGARETS SKEPHUBBLE	7-A	23-7-09	25-7-09	M. ROCK	Alan Devine (PAGE 7 BK 1)
314	DESMOND MULLALLY.	RC.	RETD.	ST. MARGARETS, DUNBRO.	OLD SECTION	19/3/10	23-3/10	M. ROCK.	Alan Devine
315.	MARGARET BROWN	RC.	RETD.	ST. MARGARETS	62 A.	26-10-10	29-10-10	M. ROCK.	Alan Devine (PAGE 12. B. 1)

DUBLIN BOARD

OF PUBLIC HEALTH.

REGISTER OF

INTERMENTS.

CHAPLEMIDWAY Burial Ground.

No. of Entry	Christian Name and Surname (in full)	Religious Persuasion	Occupation or Rank in Life	Last Place of Residence	Situation of Grave Plot	Date of Death	Date of Interment	Signature of Person having Management of Interment	Signature of Registrar
316	JOAN DAVY,	R.C.	RETD.	MADONNA LODGE, ROBSTOWN.	OLD SECTION	9/10/10	13/10/10	ROCK.	A. Lane

Comhairle Contae Fhine Gall

Fingal County Council

# DUBLIN BOARD OF PUBLIC HEALTH EXISTING BURIAL GROUND CHAPELMIDWAY

MAP SHOWING VACANT GROUND Laid OUT IN GRAVE SPACES. JANUARY 1933

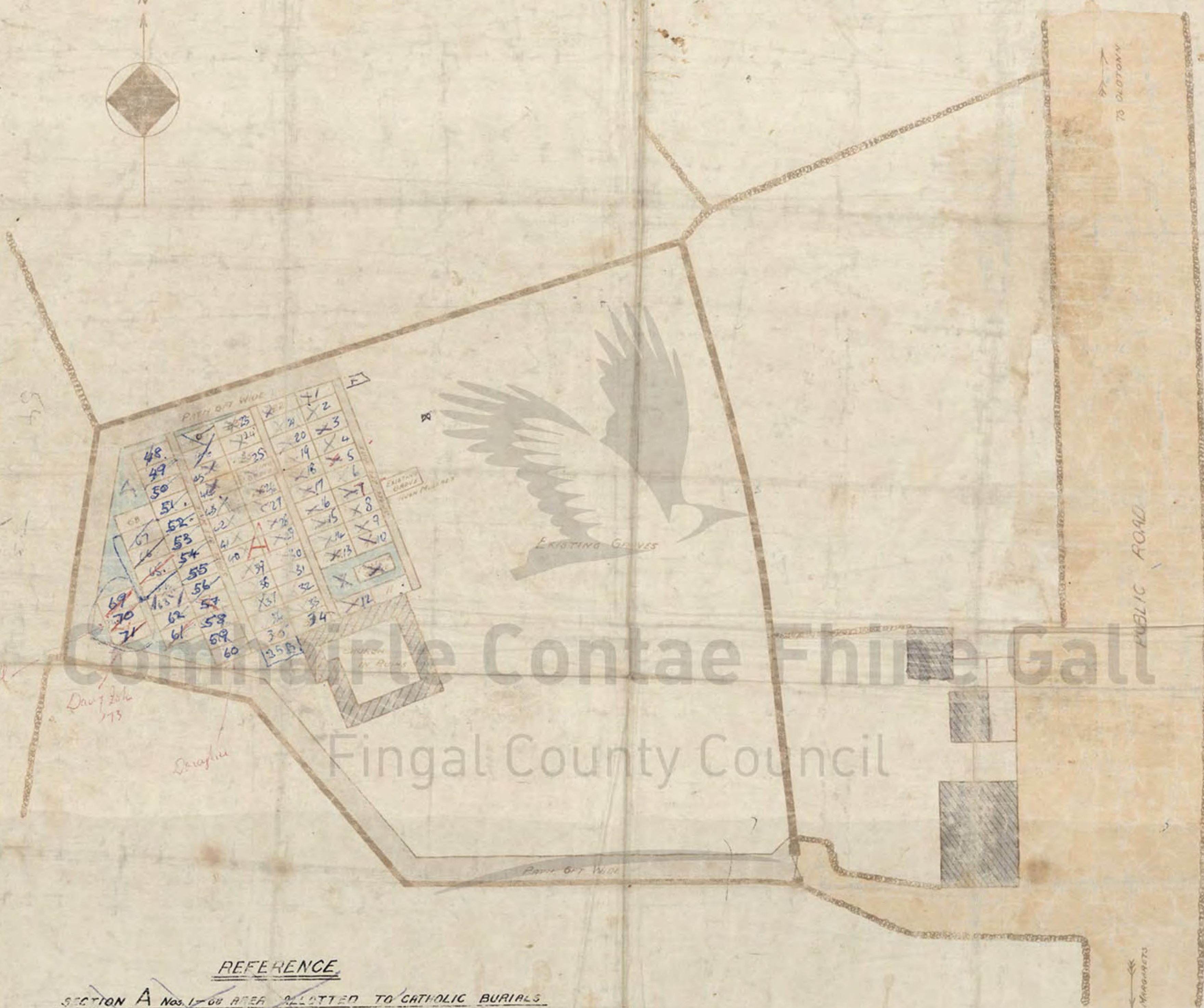

REFERENCE

~~SECTION A Nos. 1-68 AREA ALLOTTED TO CATHOLIC BURIALS  
AT £1 0-0 PER SINGLE GRAVE SPACE  
SECTION B Nos. 69-71 UNALLOTTED~~

From 1st Jan 1954 the charge for each single grave space will be £5  
L.H.L.

Scale ~ 20 Feet to One Inch.

